



IELTS LISTENING SIMULATION VOL.2

CHOOSE THE RIGHT ANSWER

SECTION 1 (1-10)

Questions 1-5

Complete the following information using **NO MORE THAN THREE WORDS AND/OR NUMBERS** for each gap.

Surname	1 <input type="text"/>
Given name	Sharon
Address	2 <input type="text"/> Evergreen, Tipton, TP3 4MB
Date of birth	3 <input type="text"/> 1956
Type of membership	annual
Amount due	4 <input type="text"/> £
Credit card number	4673 9702 0361
Expiry date	5 <input type="text"/>



Questions 6-9

Label the diagram of the gym, using **FOUR** of the following six labels.

Write the appropriate letter in the correct space on your answer sheet.

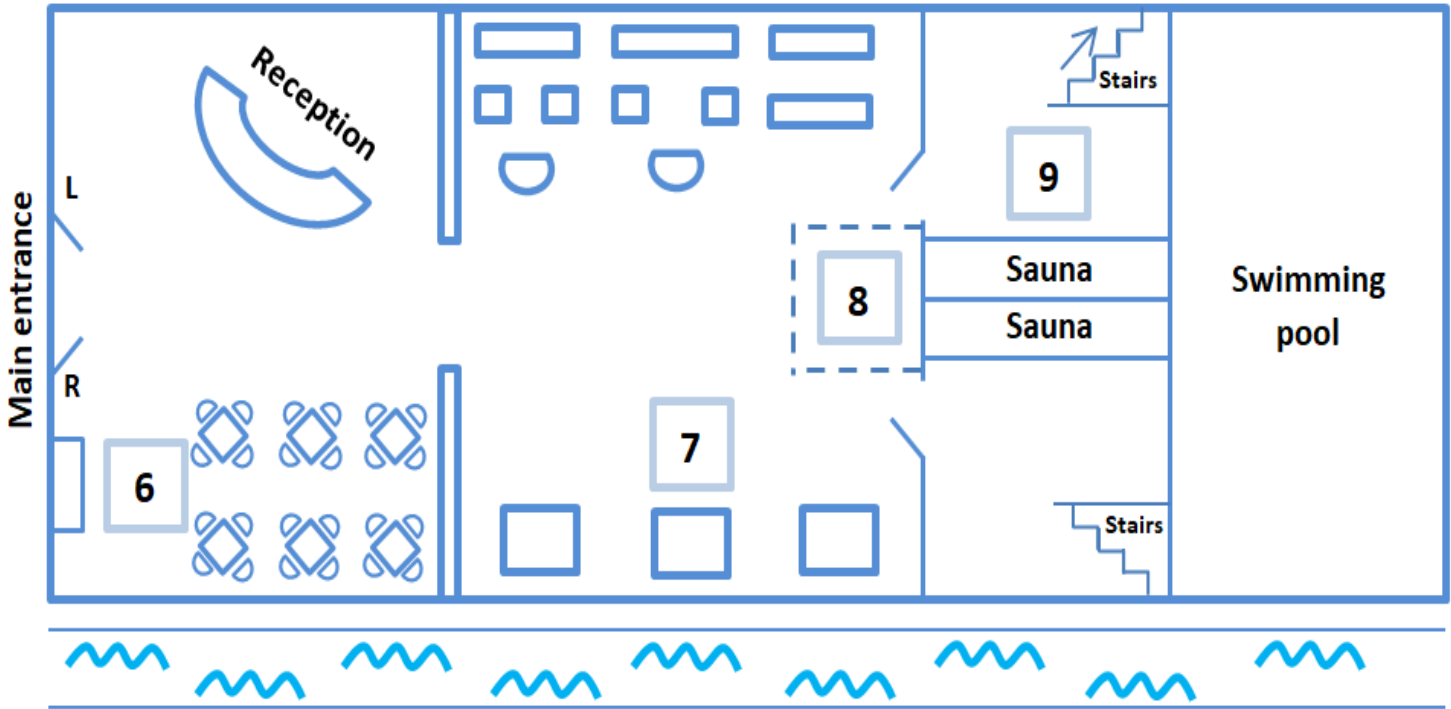

LABELS

<p>A free weights area</p> <p>B ladies' changing area</p> <p>C men's changing area</p>	<p>D refreshment area</p> <p>E treadmills</p> <p>F various machines</p>
---	--

6 [Click me!](#)

7 [Click me!](#)

8 [Click me!](#)

9 [Click me!](#)



Question 10

Decide which pair of pie charts illustrate the membership of the gym and spa and write the appropriate letter on your answer sheet.

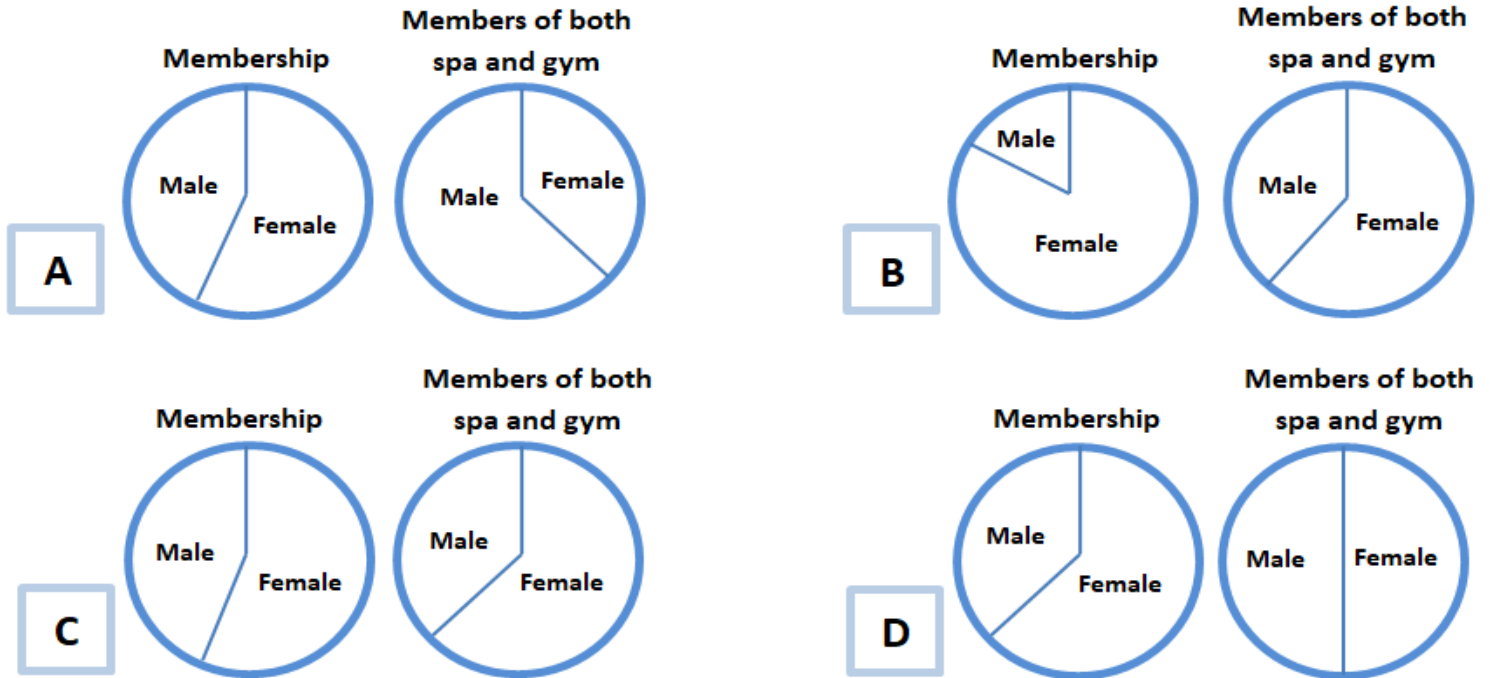

10 [Click me!](#)

SECTION 2 (11-20)

Questions 11 and 12

Complete the following sentences using **NO MORE THAN TWO WORDS** for each gap.

11 The university has produced a to inform students about the different accommodation options available.

12 All catered and self-catered accommodation is close to the .



Questions 13-16

In boxes 13 -16 on your answer sheet, write

- A if the statement applies to catered accommodation
- B if the statement applies to self-catered accommodation
- C if the statement applies to private accommodation
- D if the statement is not mentioned at all by the accommodation officer

13 Meals are included in the rent. [Click me!](#)

14 This is the best accommodation for people who want to choose when they eat. [Click me!](#)

15 Most students live in this kind of accommodation. [Click me!](#)

16 This is the most expensive type of accommodation. [Click me!](#)

Questions 17-20

Decide which letter on the map (A - J) shows the location of each of the following university halls of residence.

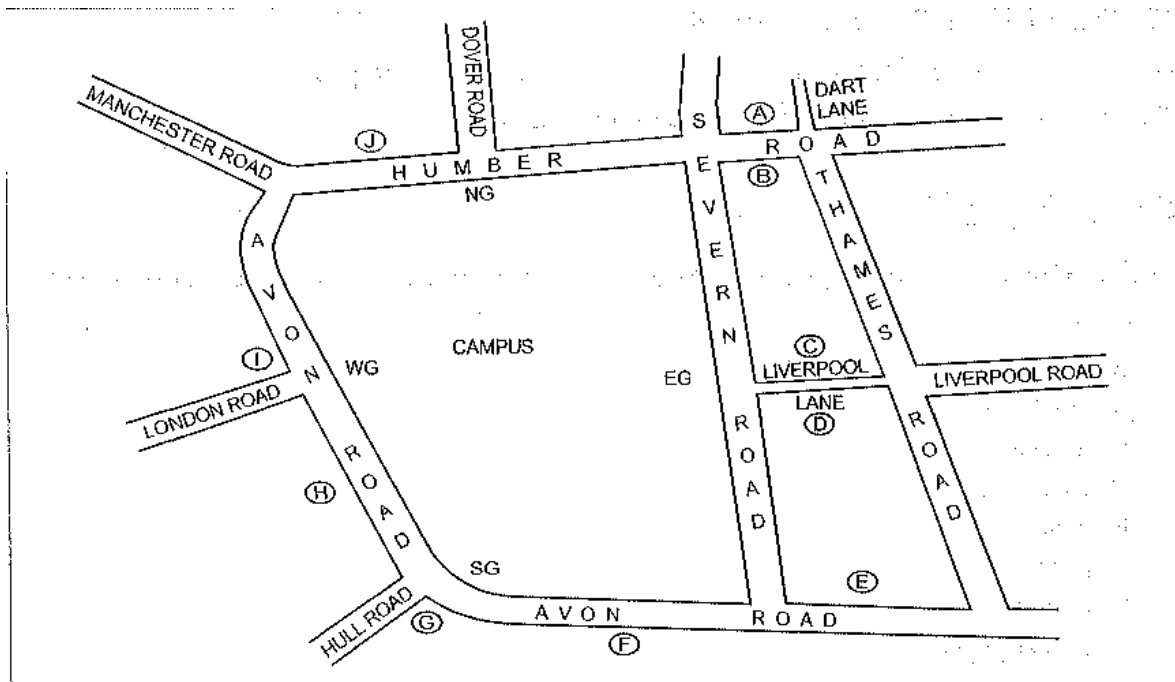

17 Malvern Halls - [Click me!](#)

19 Brecon Halls - [Click me!](#)

18 Grampian Halls - [Click me!](#)

20 Sperrin Halls - [Click me!](#)



SECTION 3 (21-30)

Questions 21-24

Answer the questions using **NO MORE THAN THREE WORDS** for each answer.

21 When did Jenny arrive at the university? _____

22 What is Tom going to study? _____

23 What is Jenny going to study? _____

24 What two items have the students been given? _____

Questions 25-27

Complete the following sentences using **NO MORE THAN TWO WORDS AND/OR NUMBERS** for each gap.

25 Tom's Halls of Residence is named _____.

26 Tom's accommodation is a _____ from the campus.

27 Jenny's accommodation is near the campus, close to the _____.

Questions 28-30

Decide which **THREE ITEMS** Jenny needs to buy and write the appropriate letters on your answer sheet in any order.

A binders

B notebooks

C notepaper

D paperclips

E pencils

F pens

G primer

H printer paper



SECTION 4 (31-40)

Question 31

Which pie chart shows the ages of the Asian students surveyed?

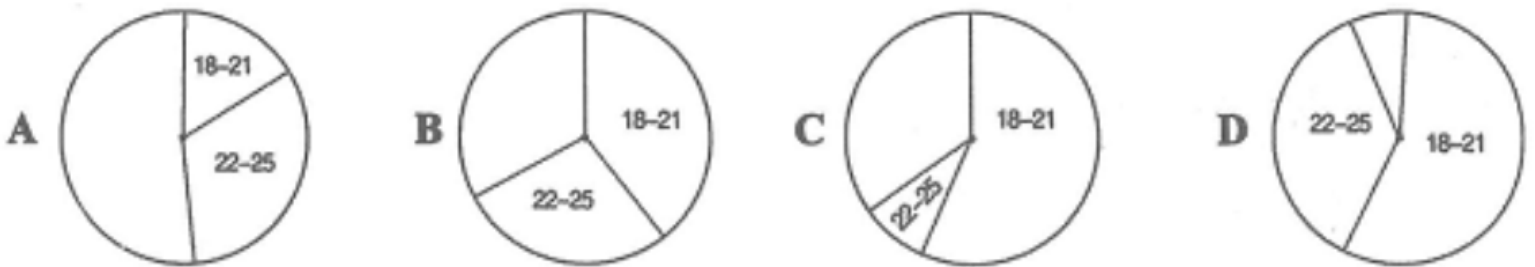

31 [Click me!](#)

Question 32

Which pie chart shows the main reasons Asian students wanted to study abroad?

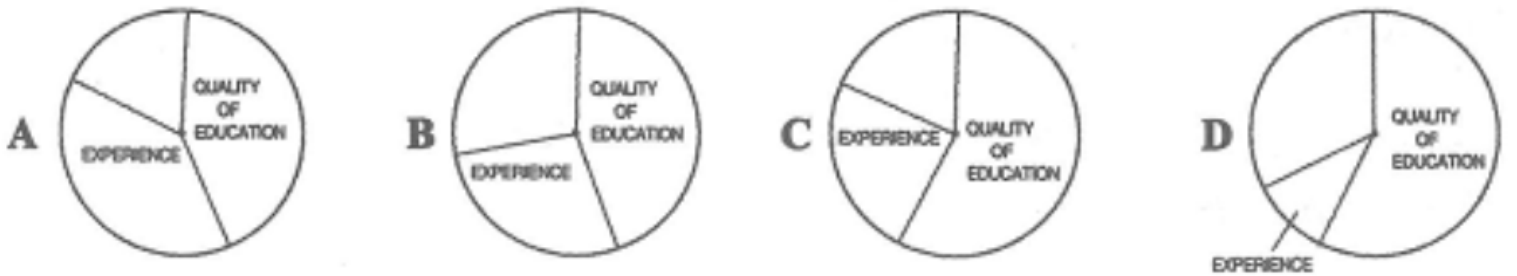

32 [Click me!](#)



Question 33

Which bar chart shows the percentage of Asian students who made Australia their first choice destination?

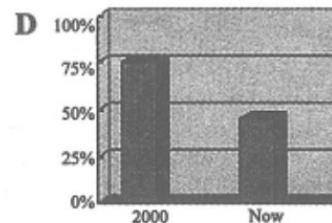
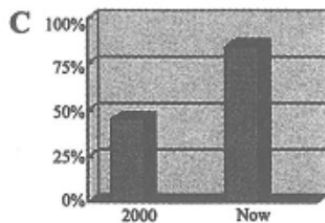
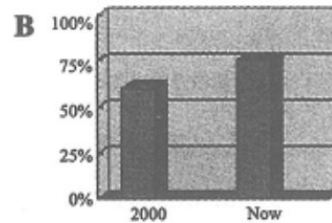
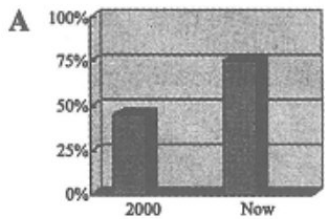

33 [Click me!](#)

Questions 34 and 35

Answer the following questions using **A NUMBER** for each answer.

34 Approximately how many foreign students enrolled in Australia in the year 2000?

35 How much did Australia's education exports rise by last year?

Questions 36-40

Complete the following sentences using **NO MORE THAN TWO WORDS OR NUMBERS** for each gap.

36 It became harder to get a for the USA after September 11.

37 of Asian students gave lower study fees as a reason for choosing Australia.

38 Asian students rank Australia number in terms of educational quality.

39 programmes are unlikely to reduce the number of students going abroad in the near future.

40 Asian students are increasingly using to help arrange their studies abroad.